

Pump Bleed-Down Valve Kit #11331

The pump bleed-down valve discharges high-pressure water from the pump when the pump is turned off. This valve operates as a normally open safety valve, which is controlled by a hydraulic solenoid valve. The bleed-down valve is located inside behind the utility panel at the rear of the pump.



Bleed-down valve repair kit

The AS Bleed-Down Valve repair kit **11331** contains one each of the following:

11323 Seal Hoop	11359 Oil Seal
11322 Needle (Stem)	11325 Seat Flow
11321 Seal, FL	11778 Piston
11324 Bushing	122880-908 O-ring (Sae fitting for Hydraulic hose if needed)
11447 Grease packet	O-rings packet (2 o-rings, 1 backup ring)

You will also need the Bleed-down valve tool (BDV) 12029 (purchased separately from AccuStream).

Kit installation procedure:

1. **Shut down** the system.
2. **Remove** the hydraulic hose and gland nut connection from the water drain tubing to the bleed-down valve.
3. **Remove** the gland nut from the collar at the high-pressure inlet port of the bleed-down valve.
4. **Disconnect** the actuator housing from the high-pressure valve assembly.
5. **Remove** the hydraulic fitting from the actuator housing.
6. **Push** the piston out of the actuator body through the oil port. Removed and discard the o-ring and backup ring from the piston. Check the piston for any damage.
7. **Install** a new o-ring and backup ring on the replacement piston (if needed) in the order shown *right*.
8. **Lubricate** the o-ring and backup ring with grease from the packet.

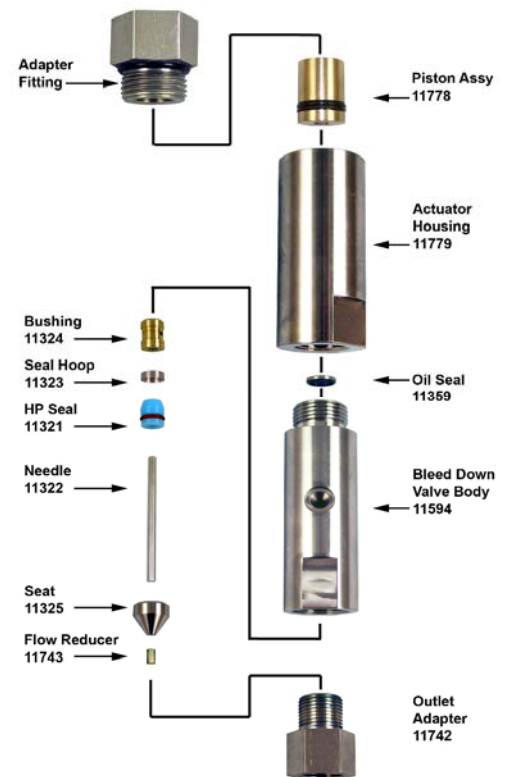

9. **Insert** the piston assembly into the actuator housing. Apply blue goop to the hydraulic fitting and secure it to the end of the actuator housing.

NOTE: In the following steps do not to remove the oil seal unless it is damaged or worn.

10. **Remove** the outlet adapter and flow reducer from the bleed-down valve body to gain access to the HP seat. Remove and discard the HP seat. The flow reducer is contained in the end of the outlet adapter and may fall out during the adapter removal.
11. With the pin end of the BDV tool, push the pin out from the oil seal end to remove the components from the valve body.
12. **Inspect** the oil seal for damage. If it appears damaged, remove with a pick and press in the replacement oil seal using a vise or small Arbor Press.

NOTE: Clean the valve body before any new parts is installed.

13. **Lubricate** the stem bushing, seal and seal hoop, with the lubricant from the grease packet.
14. **Place** the bushing, hoop, and seal on the stepped diameter end of the BDV tool in the order shown below.

NOTE: The inner diameter of the valve body has a small step, which can pinch or strip the o-ring from the HP seal during installation.



15. To help prevent the o-ring from binding, apply lubricant to the inside of the narrow opening (stepped area) inside the valve body.

16. **Insert** the tool and parts in the valve body until the tool reaches the bottom of the valve. Remove the tool and inspect the **HP seal**, look for any pinching or displacement of the o-ring.
17. **Apply** grease to the stem and **insert** the stem through the HP seal until it is flush with the oil seal on the other end.
18. Apply **Blue Goop** to the bottom of the HP Seat and install it into the bottom of the bleed-down valve body with the pointed end out.
19. Apply **Blue Goop** to the adapter fitting threads and flow reducer then thread the fitting into the valve body and torque to **35 ft-lb**.



20. **Connect** the high-pressure valve assembly to the actuator body.
21. **Reinstall** the bleed-down valve in the machine by attaching the gland nut to the high-pressure collar at the high-pressure port of the valve. Torque the collar nut to **35 ft-lb**.
22. Install the gland nut connecting the water drain tubing to the bleed-down valve.
23. **Reattach** the hydraulic hose to the oil port of the bleed-down valve.

*The intensifier is now ready for use. Turn pump on and check for any leakage.